



MEGABOOST® High/Low Manual Grease Gun

Part No. : L1180, L1185 (shown)

US Pat 7,337,927

US Pat 7,337,406

IMPORTANT!

Read all instructions and warnings before operating this product.

SAVE THESE INSTRUCTIONS!

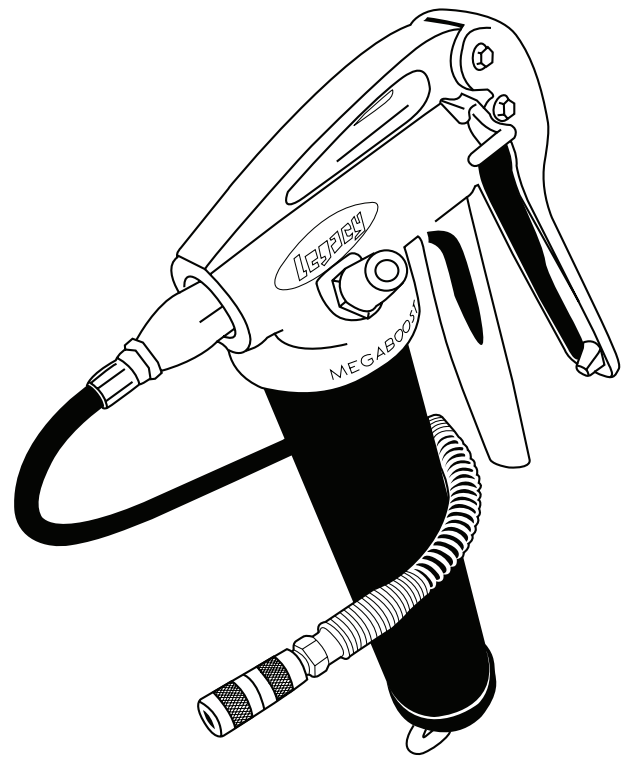

WARNING:

- **Risk of personal injury. This gun is capable of developing over 10,000 psi pressure. Do not expose skin to potential rupture sites or end of grease coupler. User should wear safety goggles while operating. Only extensions and couplers rated for this pressure are acceptable to use. If grease injection occurs, seek immediate medical attention. Do not attempt to treat the injury yourself.**
- Do not attempt to remove the inlet valve or the internal piston assembly. Reassembly of these components must be performed by trained service technicians to prevent damage. Other attempts to repair or modify will void warranty.

OPERATION:

- The switch must be set to "Volume" mode in order to properly prime the gun.
- The handle must be in the full open position to switch from "Volume" mode to "Boost" mode. Always allow the handle to fully retract before switching between modes.
- Switching from "Volume" to "Boost" mode will result in a 4:1 increase in pressure for the same grip force. The volume delivered will be decreased to approximately one-fourth while in "Boost" mode. After unblocking the obstruction, switch back to "Volume" mode for normal delivery (22 strokes / ounce).
- When full stroke of the handle is not possible due to limited space, partial strokes may be used to deliver grease at proportionally lower displacement per stroke.
- The Air-Pocket Valve may be used to expel air pockets from the head of the gun. Air pockets will prevent priming.

CARTRIDGE LOADING PROCEDURE

FIGURE 1

Unscrew gun barrel from head assembly.

FIGURE 2

- A. Pull plunger rod handle out until it stops.
- B. Then pull plunger rod to the side until it locks.

FIGURE 3

- A. Remove plastic bottom cap from grease cartridge and drop cartridge (open end down) into gun barrel.
- B. Push cartridge down until lip seats against top of gun barrel. Pull ring tab to remove seal from end of grease cartridge.

FIGURE 4

Screw gun barrel back on head assembly.

FIGURE 5

- A. Push plunger rod toward the center.
- B. Then push into barrel.

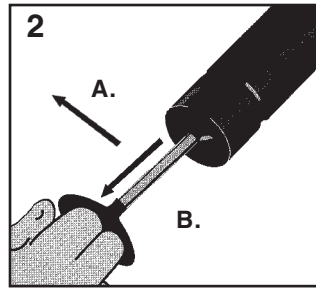
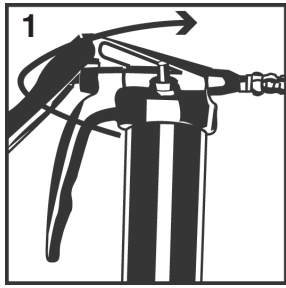

SUCTION LOADING PROCEDURE

FIGURE 6

Unscrew gun barrel from head assembly. Insert open end of gun barrel two inches below surface of grease. Slowly pull back plunger rod handle (drawing in grease). Screw gun barrel back on head assembly. Move follower rod handle to the center to unlock it & push into barrel. Use Air Pocket Valve to release trapped air. Follow priming instructions below.

MANUAL GREASE FILLER PUMP LOADING PROCEDURE

- Wipe grease filler nipple clean.
- Insert gun head loader fitting into valve of loader pump.
- Pump grease until gun is filled. When barrel is full, the rod will be fully extended, without spring tension. Push rod into barrel.

TO PRIME

Unscrew the air pocket valve located on the top of the gun in a counter-clockwise motion until grease begins to appear from the hole. Keep in this position until all air bubbles are out. Retighten valve when finished. Operate the gun trigger until grease flows from the coupler. If necessary, repeat air-bleeding steps to purge trapped air pockets from grease.

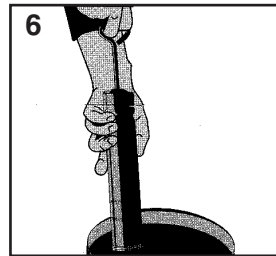
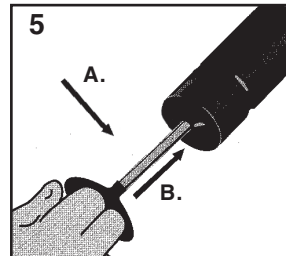
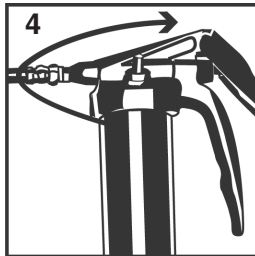
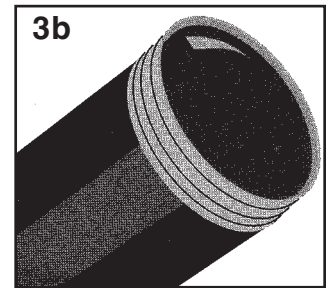
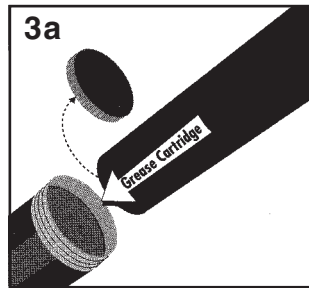

Replacement Parts:

L2810SP	MegaBoost® High Pressure Flexible Extension	L2015	MegaBoost® High Pressure 4-Jaw Coupler
RP004082	Grease Filler Nipple	L2430	Rigid Extension
RP009001	MegaBoost® Piston & Seals Assembly	L2465	Air Bleed Valve
RP009006	Barrel & Assembly		

WARRANTY*

LEGACY MANUFACTURING COMPANY (“LEGACY”) warrants that this equipment, (NOT including couplers, whip hoses, and wear items such as seals), will be free from defects in material and workmanship for a period of five (5) years from the date of purchase, under normal use.* LEGACY’S sole obligation under this warranty is limited to replacing or repairing, free of charge, equipment that proves to be defective under normal conditions and use according to the recommendations of LEGACY. LEGACY will NOT warrant this product under conditions of misuse or abuse. This warranty is void in cases where the product has been modified and/or tampered with. To obtain repair or replacement, the equipment must be shipped to a LEGACY authorized Warranty and Service Center during the warranty period, transportation charges prepaid, with proof of date of purchase. In the event of repair or replacement, the warranty period shall not be extended beyond the original warranty period.

While necessary maintenance or repairs on your Legacy equipment can be performed by any company, we recommend that you use only authorized Legacy service centers. Improper or incorrectly performed maintenance or repair voids this warranty. Contact us at service@legacymfg.com or www.legacymfg.com for ordering, installation instructions.